

In addition to these notes, reference shall be made to the specification of works and the relevant Architect's and Specialist's drawings and specifications.
The Contractor is responsible for verifying all dimensions before commencing work.

All dimensions are in millimetres unless noted otherwise.
This drawing has been produced electronically and may have been photo reduced or enlarged when printed or copied. Dimensions on this drawing shall not be scaled. Work only to ground dimensions. Any dimensional discrepancies between this drawing and the approved design shall be reported to the Engineer immediately. Levels are in metres unless noted otherwise to Ordnance Survey datum.
The Contractor is responsible for the ability of the building which the works are in progress and shall provide temporary propping for steel where necessary.

NOTES

1. This Drawing is based on Drawing Nos H39140-01-02
2. Reinforced Concrete for ground beams to be Grade RC35/20 to BS 5628.
3. Nominal cover to all ground beam reinforcement to be 40mm to links.
4. laps to reinforcement to be--
116 = 650
120 = 800
125 = 1000
132 = 1300
5. This Drawing is to be read in conjunction with Dixon Hurst Kemp Bending Schedule No. H39140-001 (01802)

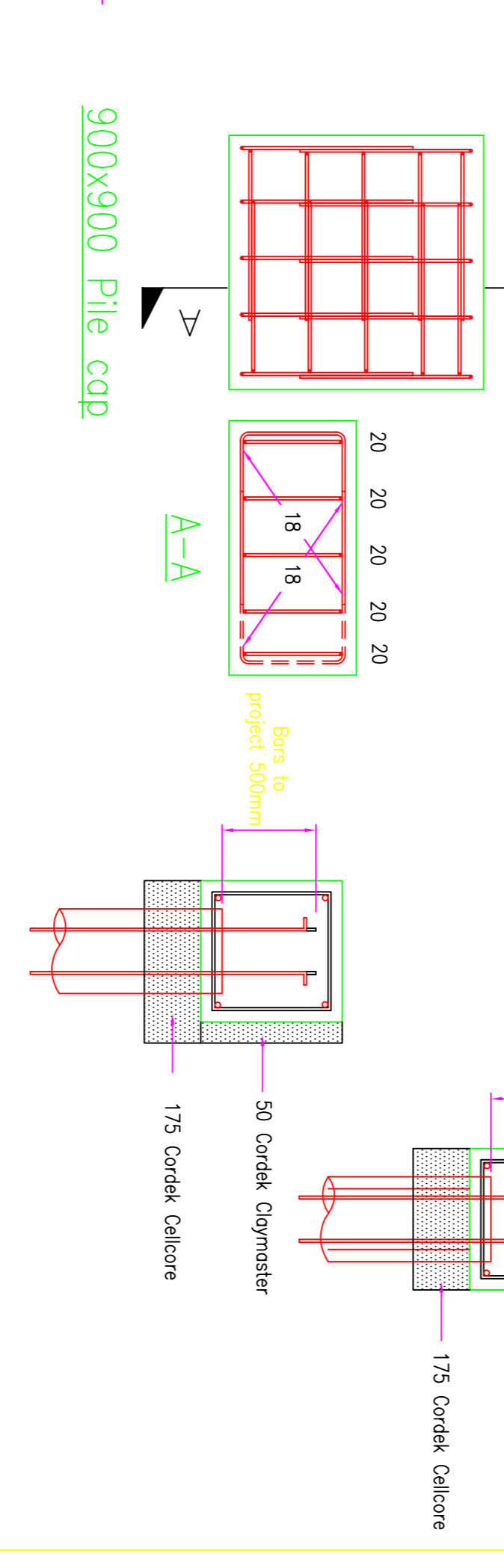
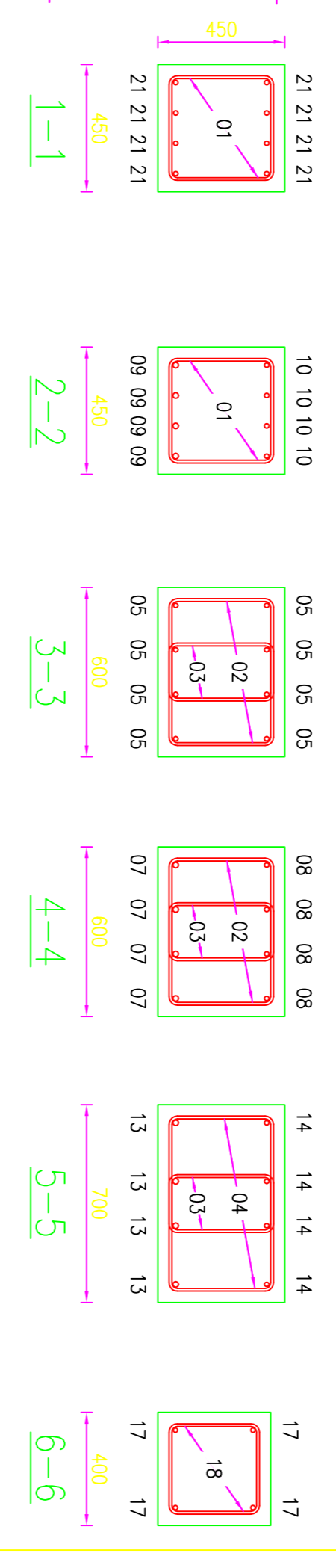

TENDER

REV	DESCRIPTION	DATE	BY
A	Issued for Tender	20.09.09	FS

DIXON
CONSULTING CIVIL & STRUCTURAL ENGINEERS
5 Genesis Business Centre,
Medway Way, Rainham,
Kent, SE20 9JG
Tel: No. 01473 201999
Fax: No. (01473) 261995
Email: kemp@dixon.co.uk
Web Site: www.dixon.co.uk

HURST

KEMP

CONTRACT
St. Margaret Citherow RC School
Quinton Street Neasden
London NW10

DRAWING
Ground Floor
Reinforcement Plan

DRAWING No.	REV	CHECKED
H39140 / 04	A	

SCALE	DATE	DRAWN	APPROVED
1:50	09/09	FS	

AutoCAD Ref: .dwg
This drawing is produced using AutoCAD. Only written dimensions are to be respected

